

# Model Type: GPD15-6SF(R)C



**Note:**

1. Motor : 2-pole single-phase
2. Liquid temperature: 36°F ~ 230°F (2°C ~110°C)
3. Max. system pressure: 145psi (1MPa)

**Performance Curve**

**Installation Drawing**

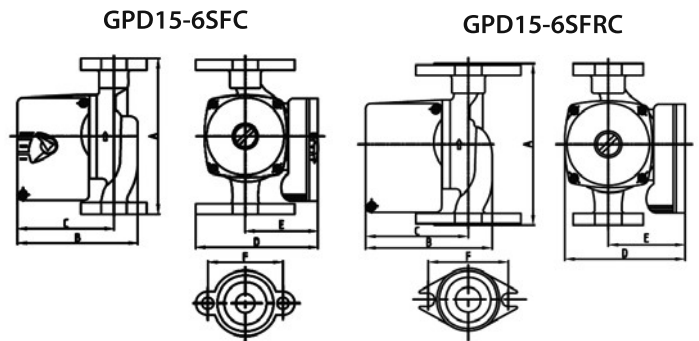
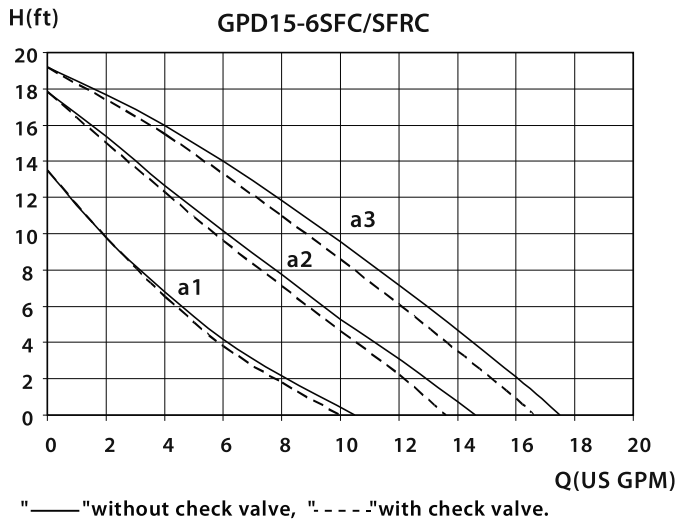

**Performance Parameter Form**

Model Type	Max. Flow(gpm)	Max. Head(ft)	Votls(V)	Amps(A)	Watts(W)	Capacitor	Curve	System type
GPD15-6SFC/SFRC	17	19	115	0.9/0.7/0.5	100/70/55	10uf/250V	a3/a2/a1	Closed
			230	0.45/0.35/0.25	100/70/55	2uf/450V		

**Installation Size Form**

Model type	A	B	C	D	E	F	Connection type and size	Shipping weight(lbs)
GPD15-6SFC	6 1/2	5 2/5	4	5 1/16	3	3 5/32	GF 15 flange (2) 1/2" dia. bolt holes	7 1/4
GPD15-6SFRC	6 1/2	6	4	4 7/8	3	3 5/32		

**Model Type: GPD15-10F**



**Note:**

1. Motor : 2-pole single-phase
2. Liquid temperature: 36°F ~ 230°F (2°C ~ 110°C)
3. Max. system pressure: 145psi (1MPa)

**Performance Curve**

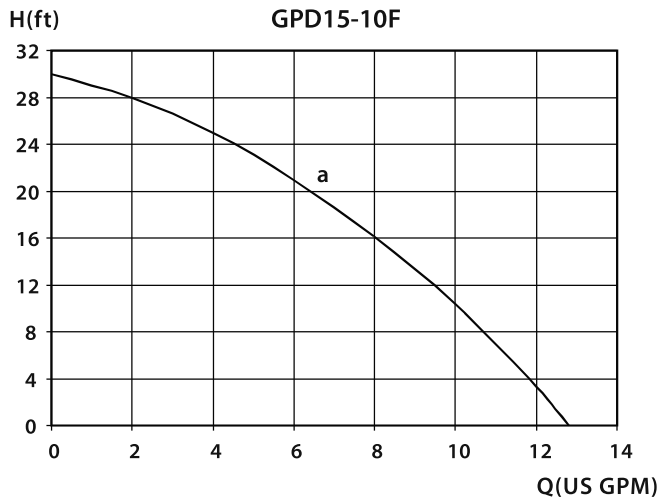

**Installation Drawing**

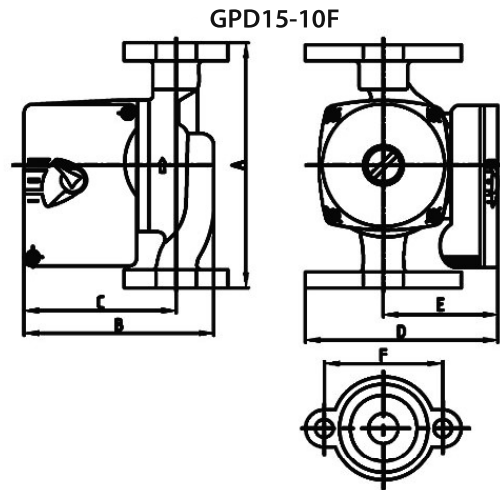

**Performance Parameter Form**

Model Type	Max. Flow(gpm)	Max. Head(ft)	Votls(V)	Amps(A)	Watts(W)	Capacitor	Curve	System type
GPD15-10F	12	31	115	1.0	120	10uf/250V	a	Closed
			230	0.5	120	3uf/450V		

**Installation Size Form**

Model type	A	B	C	D	E	F	Connection type and size	Shipping weight(lbs)
GPD15-10F	6 1/2	5 3/8	4	5 1/16	3	3 5/32	GF 15 flange (2) 1/2" dia. bolt holes	7 1/4

# Model Type: GPD25-10SFC, GPD25-7.5SFC



**Note:**

1. Motor : 2-pole single-phase
2. Liquid temperature: 36°F ~ 230°F (2°C ~ 110°C)
3. Max. system pressure: 145psi (1MPa)

**Installation Drawing**

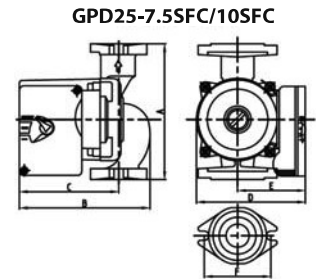

**Performance Curve**

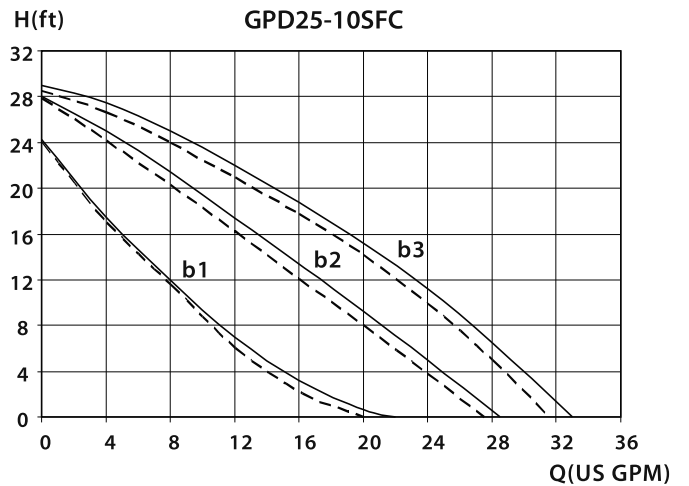
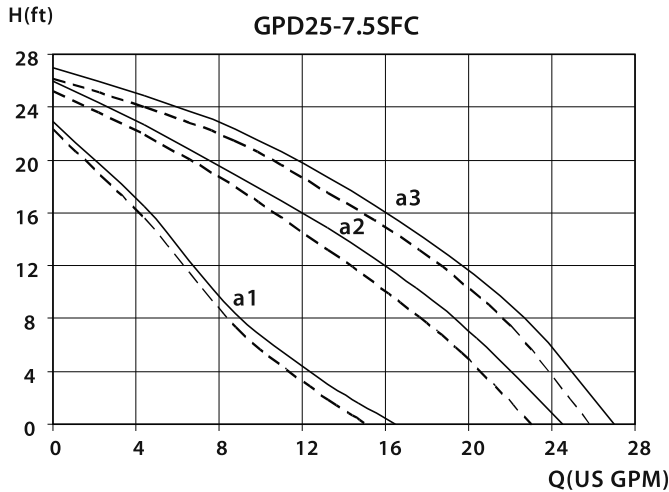

"——"without check valve, "- - -"with check valve.

**Performance Parameter Form**

Model Type	Max. Flow(gpm)	Max. Head(ft)	Votls(V)	Amps(A)	Watts(W)	Capacitor	Curve	System type
GPD25-7.5SFC	27	27	115	1.6	185/170/150	20uf/450V	a3/a2/a1	Closed
			230	0.8	185/170/150	5uf/450V		
GPD25-10SFC	32	30	115	1.6	200/190/135	20uf/200V	b3/b2/b1	Closed
			230	0.6	200/190/135	5uf/450V		

**Installation Size Form**

Model type	A	B	C	D	E	F	Connection type and size	Shipping weight(lbs)
GPD25-7.5SFC	6 1/2	6	4 3/4	5 5/16	3 1/4	3 5/32	GF 25 flange (2) 1/2" dia. bolt holes	11 1/4
GPD25-10SFC								

**Model Type: GPD25-12F**



**Note:**

1. Motor : 2-pole single-phase
2. Liquid temperature: 36°F ~ 230°F (2°C ~110°C)
3. Max. system pressure: 145psi (1MPa)

**Performance Curve**

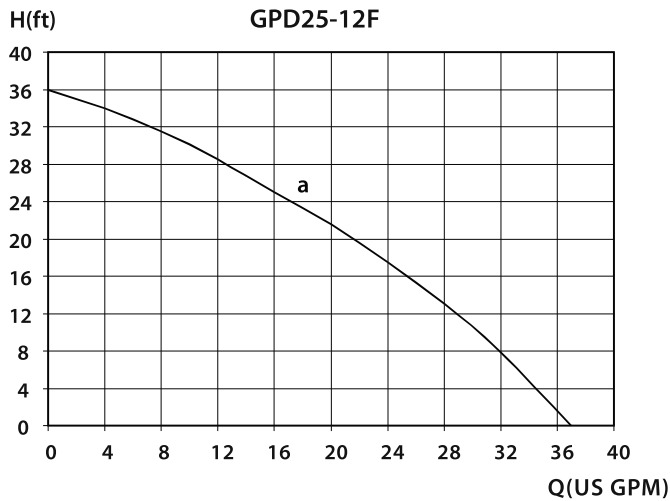

**Installation Drawing**

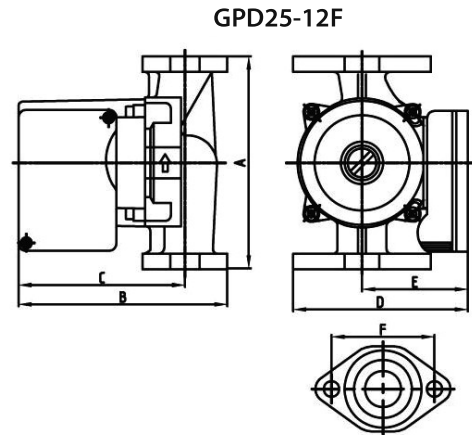

**Performance Parameter Form**

Model Type	Max. Flow(gpm)	Max. Head(ft)	VotIs(V)	Amps(A)	Watts(W)	Capacitor	Curve	System type
GPD25-12F	36	36	230	1.5	335	6uf/450V	a	Closed

**Installation Size Form**

Model type	A	B	C	D	E	F	Connection type and size	Shipping weight(lbs)
GPD25-12F	6 1/2	6 3/8	5 1/16	5 3/8	3 1/4	3 5/32	GF 15 flange (2) 1/2" dia. bolt holes	12 1/2